

WOKIN

623936

CORDLESS BLOWER

INSTRUCTION MANUAL

20V

GP^{20V}

**LITHIUM
TECH**

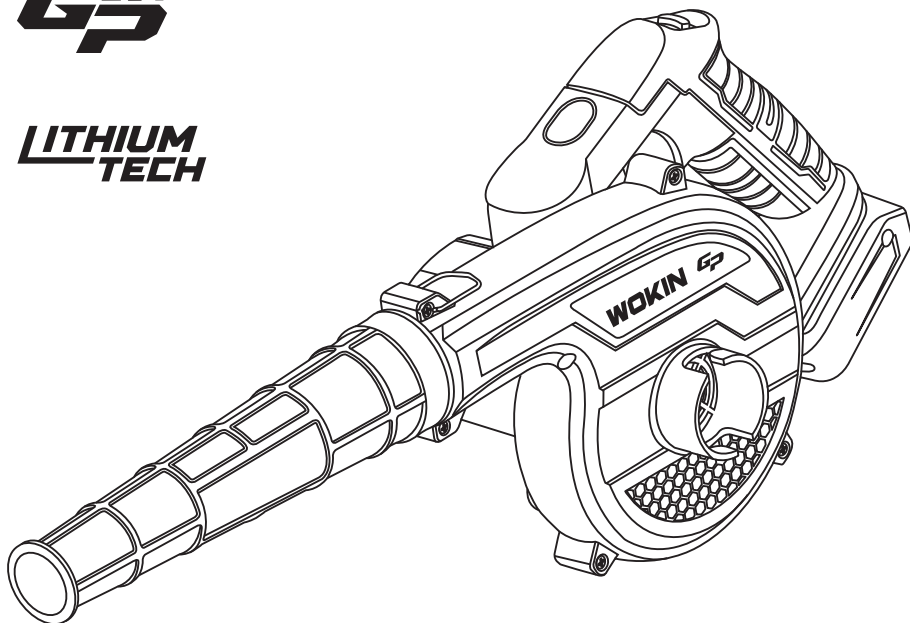

CE



SAVE THIS MANUAL!

You will need this manual for safety instructions, operating procedures and warranty.

Put it and the original sales receipt in a safe dry place for future reference.

IMPORTANT SAFETY INFORMATION

General Safety

WARNING:

Read all safety warnings and all instructions. Failure to follow the warnings and instructions may result in electric shock, fire and/or serious injury.

WARNING:

This appliance is not intended for use by persons (including children) with reduced, physical or mental capabilities or lack of experience or knowledge unless they have been given supervision or instruction concerning use of the appliance by a person responsible for their safety.

Children must be supervised to ensure that they do not play with the appliance.

Save all warnings and instructions for future reference

The term "power tool" in the warnings refers to your mains-operated (corded) power tool or battery-operated (cordless) power tool.

Work area safety

1. Keep work area clean and well lit. Cluttered or dark areas invite accidents.
2. Do not operate power tools in explosive atmospheres, such as in the presence of flammable liquids, gases or dust. Power tools create sparks which may ignite the dust or fumes.
3. Keep children and bystanders away while operating a power tool. Distractions can cause you to lose control.

Electrical safety

1. Power tool plugs must match the outlet. Never modify the plug in any way. Do not use any adapter plugs with earthed (grounded) power tools. Unmodified plugs and matching outlets will reduce risk of electric shock.
2. Avoid body contact with earthed or grounded surfaces, such as pipes, radiators, ranges and refrigerators. There is an increased risk of electric shock if your body is earthed or grounded.
3. **DO NOT** expose power tools to rain or wet conditions. Water entering a power tool will increase the risk of electric shock.
4. **DO NOT** abuse the cord. Never use the cord for carrying, pulling or unplugging the power tool. Keep cord away from heat, oil, sharp edges or moving parts. Damaged or entangled cords increase the risk of electric shock.
5. When operating a power tool outdoors, use an extension cord suitable for outdoor use. Use of a cord suitable for outdoor use reduces the risk of electric shock.
6. If operating a power tool in a damp location is unavoidable, use a residual current device (RCD) or ground fault circuit interrupter (GFCI) protected supply. Use of an RCD or GFCI reduces the risk of electric shock.
7. Power tools can produce electromagnetic fields [EMF] that are not harmful to the user. However, users of pacemakers and other similar medical devices should contact the maker of their device and/or doctor for advice before operating this power tool.

Personal safety

1. Stay alert, watch what you are doing and use common sense when operating a power tool. Do not use a power tool while you are tired or under the influence of drugs, alcohol or medication. A moment of inattention while operating power tools may result in serious personal injury.
2. Use personal protective equipment. Always wear eye protection. Protective equipment such as dust mask, non-skid safety shoes, hard hat, or hearing protection used for appropriate conditions will reduce personal injuries.
3. Prevent unintentional starting. Ensure the switch is in the off-position before connecting to power source and/or battery pack, picking up or carrying the tool. Carrying power tools with your finger on the switch or energising power tools that have the switch on invites accidents.
4. Remove any adjusting key or wrench before turning the power tool on. A wrench or a key left attached to a rotating part of the power tool may result in personal injury.
5. **DO NOT** overreach. Keep proper footing and balance at all times. This enables better control of the power tool in unexpected situations.
6. Dress properly. Do not wear loose clothing or jewellery. Keep your hair, clothing and gloves away from moving parts. Loose clothes, jewellery or long hair can be caught in moving parts.
7. If devices are provided for the connection of dust extraction and collection facilities, ensure these are connected and properly used. Use of dust collection can reduce dust-related hazards.
8. Do not let familiarity gained from frequent use of tools allow you to become complacent and ignore tool safety principles. A careless action can cause severe injury within a fraction of a second.

Power tool use and care

1. **DO NOT** force the power tool. Use the correct power tool for your application. The correct power tool will do the job better and safer at the rate for which it was designed.
2. **DO NOT** use the power tool if the switch does not turn it on and off. Any power tool that cannot be controlled with the switch is dangerous and must be repaired.
3. Disconnect the plug from the power source and/or the battery pack from the power tool before making any adjustments, changing accessories, or storing power tools. Such preventive safety measures reduce the risk of starting the power tool accidentally.
4. Store idle power tools out of the reach of children and do not allow persons unfamiliar with the power tool or these instructions to operate the power tool. Power tools are dangerous in the hands of untrained users.
5. Maintain power tools. Check for misalignment or binding of moving parts, breakage of parts and any other condition that may affect the power tool's operation. If damaged, have the power tool repaired before use. Many accidents are caused by poorly maintained power tools.
6. Keep cutting tools sharp and clean. Properly maintained cutting tools with sharp cutting edges are less likely to bind and are easier to control.
7. Use the power tool, accessories and tool bits etc. in accordance with these instructions, taking into account the working conditions and the work to be performed. Use of the power tool for operations different from those intended could result in a hazardous situation.
8. Keep handles and grasping surfaces dry, clean and free from oil and grease. Slippery handles and grasping surfaces do not allow for safe handling and control of the tool in unexpected situations.

Battery Tool Use and Care

1. Recharge only with the charger specified by the manufacturer. A charger that is suitable for one type of battery pack may create a risk of fire when used with another battery pack.
2. Use power tools only with specifically designated battery packs. Use of any other battery packs may create a risk of injury and fire.
3. When battery pack is not in use, keep it away from other metal objects, like paper clips, coins, keys, nails, screws or other small metal objects that can make a connection from one terminal to another. Shorting the battery terminals together may cause burns or a fire.
4. Under abusive conditions, liquid may be ejected from the battery; avoid contact. If contact occurs, flush with water. If liquid contacts eyes, additionally seek medical help. Liquid ejected from the battery may cause irritation or burns.
5. Do not use a battery pack or tool that is damaged or modified. Damaged or modified batteries may exhibit unpredictable behaviour resulting in fire, explosion or risk of injury.
6. Do not expose a battery pack or tool to fire or excessive temperature. Exposure to fire or temperature above 130 °C may cause explosion.
7. Follow all charging instructions and do not charge the battery pack or tool outside the temperature range specified in the instructions. Charging improperly or at temperatures outside the specified range may damage the battery and increase the risk of fire.

Service

1. Have your power tool serviced by a qualified repair person using only identical replacement parts. This will ensure that the safety of the power tool is maintained.
2. Never service damaged battery packs. Service of battery packs should only be performed by the manufacturer or authorized service providers.
3. Follow instruction for lubricating and changing accessories.

Cordless Blower Safety Warnings

1. This blower is designed for blowing in and around the garage, shop or home. This is not recommended for rough, porous or uneven surfaces. This device is not designed for industrial applications. The device cannot be used for other purposes than its intended use.
2. Wear ear protectors. Exposure to noise can cause hearing loss. Wear safety goggles or eye protection when using this power tool. For additional protection against electric shock, be sure to wear rubber gloves.
3. Do not operate the tool near people, especially children or pets. Turn it off if they get too close. Maintain a safe distance of at least 5m from other people when using the tool. Never direct the blower towards bystanders or pets.
4. Only operate the tool during broad daylight or with adequate artificial light. Do not switch on the tool in enclosed or poorly ventilated spaces or in the presence of inflammable, explosive substances such as liquids, gasses and powders.
5. Do not get distracted and always concentrate on what you are doing. Use common sense. Never operate the tool when you are tired, sick or under the influence of alcohol or other drugs.
6. Keep all the air intakes and the blower tube free of dust, lint, hair and other material that may cause a reduction in air flow.
7. Prevent unintentional starting, ensure the switch is in the off-position before connecting to battery pack, picking up or carrying the appliance. Never blow dangerous materials, such as nails, fragments of glass, or blades.
8. Switch the motor off and remove the battery when the tool is not being used, left unattended, being cleaned or being moved from one place to another. When the tool is not in use, store it in a dry place and out of reach of children.

Battery Safety

WARNING:

Li-Ion batteries, if incorrectly used, stored or charged are a fire, burn and explosion hazard.

1. Keep the battery out of reach of children.
2. ONLY charge Li-Ion batteries using the charger provided or designed specifically for your product.
3. ONLY use Li-Ion batteries provided with a product or specifically designed to be compatible.
4. Allow batteries to cool for 15 minutes after charging or heavy use. Failure to follow these instructions may cause overheating or fire.
5. When not in use batteries should be stored at room temperature.
6. Ensure that battery contacts cannot accidentally short in storage. Keep batteries clean; foreign objects or dirt may cause a short. Keep away from other metal objects, for example, paperclips, coins, keys, nails and screws.
7. Under abusive conditions, liquid may be ejected from the battery. This liquid may cause skin irritation or burns. Avoid contact. If contact accidentally occurs, flush with water. If liquid contacts eyes, seek medical help.
8. DO NOT open, disassemble, crush, heat above 60°C or incinerate. Do not dispose of in fire or similar.

Battery Charger Safety

Use the battery charger correctly

1. Refer to the section of this manual relating to use of the battery charger before attempting to charge the battery.
2. Do not attempt to use the charger with any batteries other than those supplied. Keep your battery charger clean; foreign objects or dirt may cause a short or block air vents. Failure to follow these instructions may cause overheating or fire.
3. If the supply cord is damaged, it must be replaced by the manufacturer, its service agent or similarly qualified persons in order to avoid a hazard.

WARNING:

This charger can only be used to charge the batteries which has WOKIN GP20V symbol. If it is used to charge other kinds of batteries, there is a risk of explosion.

DO NOT attempt to recharge non-rechargeable batteries.

SAVE THESE INSTRUCTIONS

WARNING:

DO NOT let comfort or familiarity with product [gained from repeated use] replace strict adherence to safety rules for the subject product. MISUSE or failure to follow the safety rules stated in this instruction manual may cause serious personal injury.

SPECIFICATIONS

Voltage	20VDC
Blowing Speed	55 m/s (123MPH)
Blowing Volume	2.6m³/min (92CFM)



1. Due to our continuing program of research and development, the specifications herein are subject to change without notice.

Note: Symbology

Pay attention to all the signs and symbols shown in these instructions and on your tool. Make a note of these signs and symbols. If you interpret the signs and symbols correctly, your work with the machine will be safer and better.

	Read the instructions for use before starting the machine.
	Wear safety goggles.
	Wear ear protection.
	Wear good quality, strong gloves.
	Always use breathing apparatus when machining materials which generate dust.
	Operating environmental temperature.
	Keep away from fire
	Do not throw it into water

	WARNING
	Battery pack is part of the recyclable resources
	Class II
	For indoor use only
	Polarity
	Waste electrical products should not be disposed of with household waste. Please recycle where facilities exist. Check with your Local Authority or retailer for recycling advice.
	Batteries and rechargeable batteries are not household waste! As a consumer, you are required by law to dispose of all batteries and accumulators, whether or not they contain harmful substances *, at a collection point in your municipality / neighborhood or in commerce so that they can be disposed of in an environmentally sound manner.

FUNCTIONS

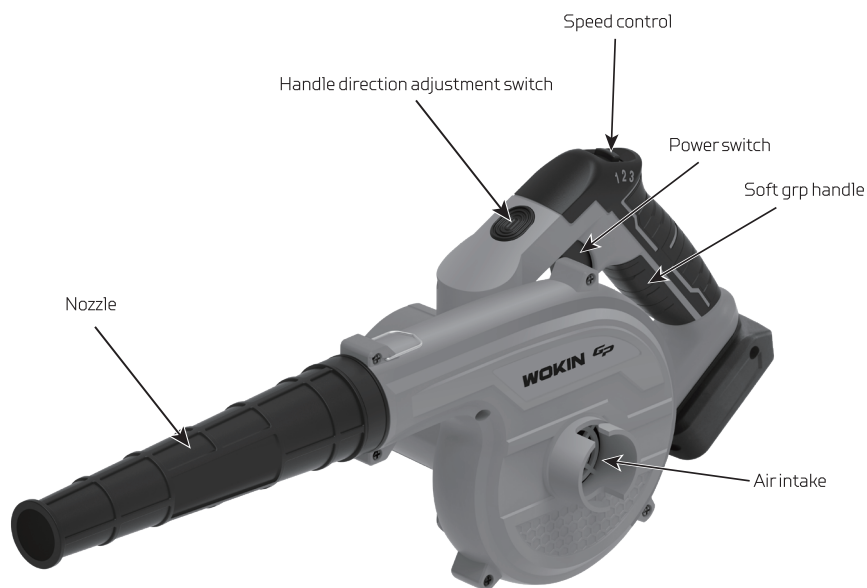

ON/OFF SWITCH

1. Before starting ensure the rotational direction switch is in the centre position to avoid accidental starting.
2. To start the machine, press and hold the ON/OFF switch.
3. Power light lights up when the ON/OFF switch fully/partially pressed.
4. To switch off the machine, release the ON/ OFF switch.



SPEED ADJUSTMENT

1. Speed adjustment switch provided for various blow speeds.
2. Speed control switch is located on the top of the handle.



HANDLE DIRECTION ADJUSTMENT

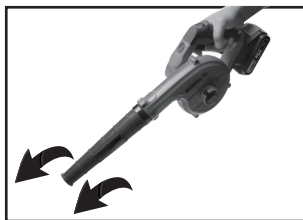
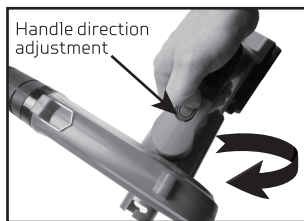

1. Press the adjust button to overturn the machine, then set the machine at suction mode.

BLOWING ASSEMBLY

1. Align the pin located outside the blast port with the notch provided on the nozzle . To lock the Nozzle in place, push the nozzle further until pin locks in the notch.
2. To remove Nozzle, press the pin and pull out the nozzle.

VACCUING ASSEMBLY

1. For dust collection, mount the Dust Bag at the Blast Port and Nozzle at the Suction Port.
2. To remove Dust Bag and Nozzle, simply pull out by first turning in the opposite direction. Empty the Dust Bag frequently to ensure maximum dust collecting efficiency.

GENERAL OPERATION

1. Check the product and charger as well as accessories for damage before each use. Do not use the product if it is damaged or shows wear. Double check that the accessories and attachments are properly fixed.
2. Always hold the product on its handle. Keep the handle dry to ensure safe support.
3. Switch the product off immediately if you are disturbed while working by other people entering the working area. Always let the product come to complete stop before putting it down.
4. Do not overwork yourself. Take regular breaks to ensure you can concentrate on the work and have full control over the product.

WARNING:

1. **Do not switch the blower in an enclosed or poorly ventilated spaces or in the presence of flammable and/or explosive liquids, gases and powders.**
2. **Check the product as well as accessories for damage before each use. Do not use the if it is damaged or shows wear.**
3. **Do not overwork yourself.**
4. **Always hold the product on its handle.**

OPERATING THE BLOWER



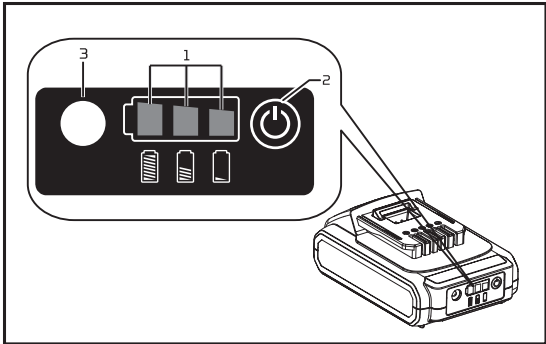

1. To switch your Blower on, depress the trigger switch. To stop your blower, release the switch.
2. Tool speed would be increased by speed control switch.
3. With the two modes of assembly options, you can perform both Blowing and Vacuuming functions for blowing-off obstacles and dust collection respectively.

INDICATING THE REMAINING BATTERY PACK



1. Indicator lamps 2. Check button. 3.DC port

Press the check button on the battery pack to indicate the remaining battery capacity. The indicator lamps light up for a few seconds.

Indicator lamps		Remaining capacity
 Lighted	 Off	
		75% to 100%
		35% to 75%
		5% to 35%

NOTE: Depending on the conditions of use and the ambient temperature, the indication may differ slightly from the actual capacity.

MAINTENANCE

WARNING: ALWAYS disconnect from the mains power supply, before carrying out any maintenance/cleaning of the charger. Remove the battery before carrying out any maintenance/cleaning of the appliance.

Note: Both the appliance and the charger contain no user-serviceable parts. If the device does not perform as outlined in this manual, return it to an authorised service centre for repair.

General Inspection

1. Regularly check that all the fixing screws are tight.
2. Inspect the supply cord of the tool, prior to each use, for damage or wear. Repairs should be carried out by an authorised service centre. This advice also applies to extension cords used with this too.

Cleaning

1. Keep your tool clean at all times. Dirt and dust will cause internal parts to wear quickly, and shorten the machine's service life. Clean the body of your machine with a soft brush, or dry cloth. If available, use clean, dry, compressed air to blow through the ventilation holes.
2. Clean the tool casing with a soft damp cloth using a mild detergent. Do not use alcohol, petrol or strong cleaning agents.
3. Never use caustic agents to clean plastic parts.

Lubrication

1. Slightly lubricate all moving parts at regular intervals with a suitable spray lubricant.

Storage

1. Store this tool carefully in a secure, dry place out of the reach of children.
2. Do not store the tool and battery pack in locations where the temperature may reach or exceed 40 °C.

Disposal

Always adhere to national regulations when disposing of power tools that are no longer functional and are not viable for repair.

1. Do not dispose of power tools, or other waste electrical and electronic equipment (WEEE), with household waste.
2. Contact your local waste disposal authority for information on the correct way to dispose of power tools

TROUBLESHOOTING

Problem	Possible causes	Likely solutions
Tool will not start.	<ol style="list-style-type: none"> 1. Battery Pack not properly connected. 2. Battery Pack not properly charged. 3. Battery Pack worn out. 4. Internal damage or wear. 5. Contact chips of switch or battery pack deformed. 6. Battery is not suitable for WOKIN GP20V lithium-ion power platform system 7. Overload operation. 8. PCB damages. 9. Motor damages. 	<ol style="list-style-type: none"> 1. Remove Battery Pack, make sure there are no obstructions, clean battery contacts on tool, reinsert the Battery Pack according to its shape (it should only fit one way), and press firmly until the Battery Pack locks in place. 2. Make sure Charger is connected and operating properly. Give enough time for Battery Pack to recharge properly. 3. Dispose of old Battery Pack properly or recycle. Replace Battery Pack. 4. Have technician service tool. 5. Replace switch or Battery Pack 6. Replace the battery of WOKIN GP20V 7. Stop to use and restart the machine after cooling. 8. Replace damaged PCB. 9. Replace damaged motor.
Tool operates slowly.	<ol style="list-style-type: none"> 1. Carbon brushes worn or damaged. 2. Chuck damaged. 3. Battery Pack worn out. 	<ol style="list-style-type: none"> 1. Have qualified technician replace brushes. 2. Have qualified technician replace chuck. 3. Dispose of old Battery Pack properly or recycle. Replace Battery Pack.
Excessive noise or rattling.	Internal damage or wear. [gear or bearings, for example.]	Have technician service tool.

CE DECLARATION OF CONFORMITY

WE
ZJG WOKIN INDUSTRIAL CO.,LTD.
350 YANGJIN ROAD, ZHANGJIAGANG,
JIANGSU, CHINA.

Declare that the product

623936
CORDLESS BLOWER

Complies with the essential health and safety requirements of the following Directices:

council directive 2006/42/EC

Standards and technical specifications referred to:

EN60335-1:2012+A1+A2+A11+A13+A14+A15

EN50636-2-100:2014

EN IEC 55014-1 : 2021

EN IEC 55014-2 : 2021

the EMC directive (2014/30/EU)

Authorised Signatory and technical file holder

Signed for and on behalf of:

ZJG WOKIN INDUSTRIAL CO.,LTD.
350 YANGJIN ROAD, ZHANGJIAGANG,
JIANGSU, CHINA.
CHEN XIAO CHENG
Group Quality Director

on:07/02/2022

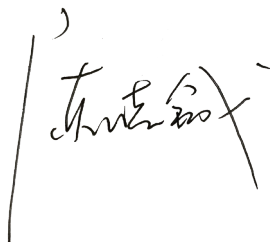
A handwritten signature in black ink, appearing to read 'Chen Xiao Cheng', is written over a vertical line. The signature is stylized and includes a small mark above the first character.

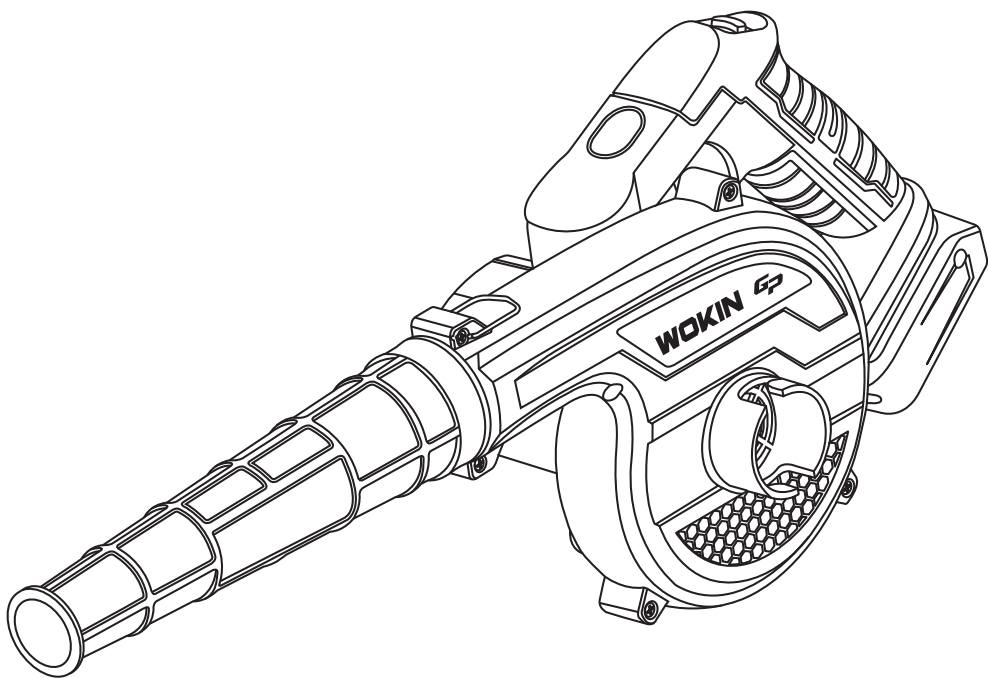

**ZJG WOKIN
INDUSTRIAL
CO.,LTD.**

www.wokintools.com

*PROFESSIONALLY
MADE IN CHINA*

WOKIN is a trademark or
registered trademark of
WOKIN TOOLS.

All rights reserved.

