

# WOKIN

857207

## HIGH PRESSURE WASHER

## INSTRUCTION MANUAL

**12A**  
**1400W**  
110-120V  
60Hz

**105BAR**  
1500psi

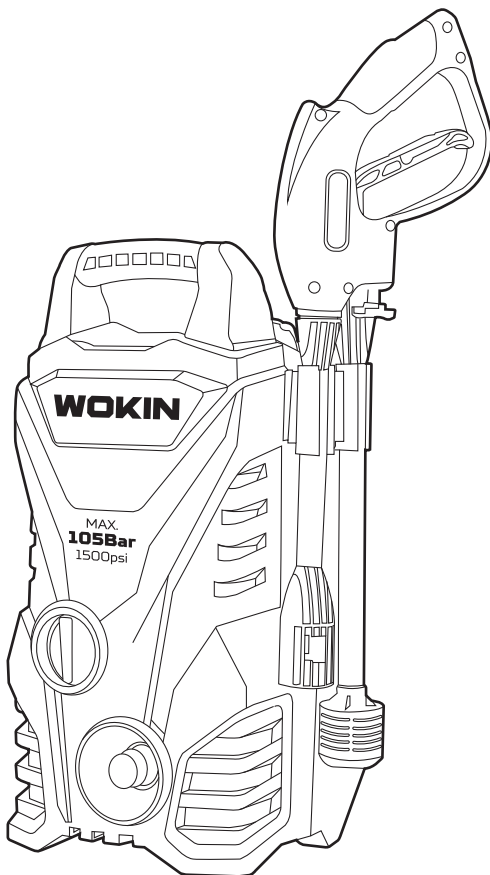

### SAVE THIS MANUAL!

You will need this manual for safety instructions, operating procedures and warranty.  
Put it and the original sales receipt in a safe dry place for future reference.

## GENERAL POWER TOOL SAFETY WARNINGS

**⚠ WARNING: Read all safety warnings and all instructions Failure to follow the warnings and instructions may result in electric shock, fire and/or serious injury.**

**Save all warnings and instructions for future reference.**

- This appliance is not intended for use by persons (including children) with reduced physical, sensory or mental capabilities or lack of experience and knowledge, unless they have been given supervision or instruction concerning use of the appliance by a person responsible for their safety.
- Children should be supervised to ensure that they do not play with the appliance.
- If the supply cord is damaged, it must be replaced by the manufacturer, its service agent or similarly qualified persons in order to avoid a hazard.

## ADDITIONAL POWER TOOL SAFETY WARNINGS

**⚠ WARNING: Do not use the appliance without reading the instruction sheet.**

- Safety boots, safety gloves, safety helmets with visors, hearing protection etc. shall be worn while operating the machine.
- When opening the trigger gun, there is a danger of the kickback force and the sudden torque on the spray assembly. Please hold the nozzles.
- **WARNING: This machine has been designed for use with the cleaning agent supplied or recommended by the manufacturer. The use of other cleaning agents or chemicals may adversely affect the safety of the machine.**
- **WARNING: High pressure jets can be dangerous if subject to misuse. The jet must not be directed at persons, live electrical equipment or the machine itself.**
- **WARNING: Do not use the machine within range of persons unless they wear protective clothing.**
- **WARNING: Do not direct the jet against yourself or others in order to clean clothes or foot-wear.**  
Disconnect from the electrical power supply before carrying out user maintenance.  
High pressure cleaner should not be taken by children or untrained persons.
- **WARNING: Risk of explosion – Do not spray flammable liquids.**
- **WARNING: To ensure machine safety, use only original spare parts from the manufacturer or approved by the manufacturer.**
- **WARNING: High pressure hoses, fittings and couplings are important for the safety of the appliance. Use only hoses, fittings and couplings recommended by the manufacturer.**
- **WARNING: Water that has flown through back flow prevent is considered to be non-potable.**  
**WARNING: The machine shall be disconnected from its power source by removing the plug from the socket outlet during cleaning or maintenance and when replacing parts or converting the machine to another function.**
- **WARNING: Do not use machine if a supply cord or important parts of the machine are damaged, e.g. safety devices, high pressure hoses, trigger gun.**
- **WARNING: If an extension cord is used, the plug and socket must be of watertight construction.**
- **WARNING: Inadequate extension cords can be dangerous.**
- The electric supply connection shall be made by a qualified electrician and comply with IEC 60364-1. It is recommended that the electric supply to this machine should include either a residual current device that will interrupt the supply if the leakage current to earth exceeds 30 mA for 30 ms or a device that will prove the earth circuit.

### IMPORTANT SAFETY INFORMATION

#### Do not suggest self priming

This appliance is not intended for use by persons (including children) with reduced physical, sensory or capabilities, or lack of experience and knowledge, unless they have been given supervision or instruction concerning use of the appliance by a person responsible for their safety.

Children should be supervised to ensure that they do not play with the appliance.

### ASSEMBLY

#### 1. ASSEMBLING GUN HOOK

Press the gun hook to the machine.



#### 2. ASSEMBLING THE HANDLE

Slide the handle to the machine. Assemble it with 2 screws.

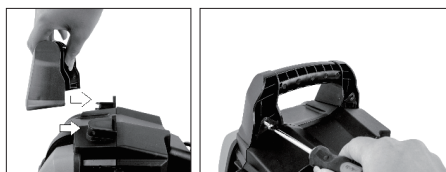

#### 3. ASSEMBLING CABLE HOOK

Press the cable hook to the machine, and fix the four screws.

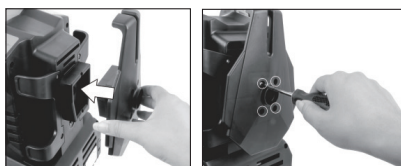

#### 4. INLET FILTER CONNEC

Remove the protection cap[a] of inlet firstly.  
Attach the inlet filter to the machine's inlet.

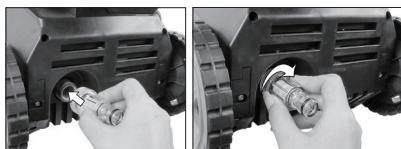

### 5. GUN CONNECTION

Insert the spray lance into spray gun, and twist 1/4 turn until rectangular tab appears. Then insert the nozzle.

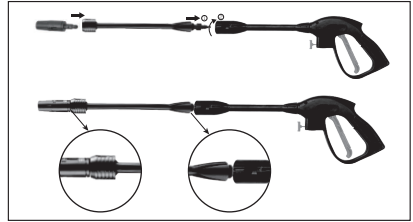

### 6. ASSEMBLING HIGH PRESSURE HOSE

- 1) Make sure that ON/OFF switch is in OFF position.
- 2) Tighten the high pressure hose into spray gun. But do not over tighten.
- 3) Remove the protection cap [b] of outlet firstly, then connection the pressure hose to the machine's outlet, make sure it is connected firmly.

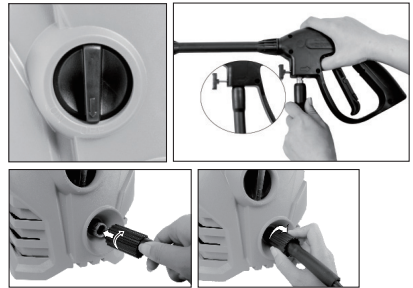

### 7. SOAP BOTTLE CONNECTION

Insert the soap bottle into spray gun, and twist 1/4 turn.

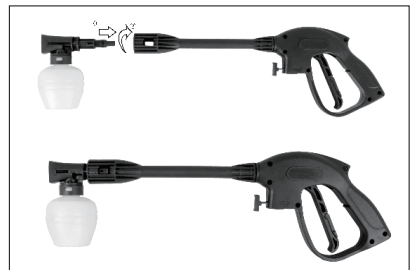

COMPONENT LIST

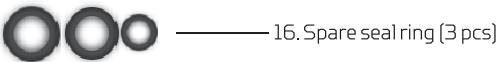
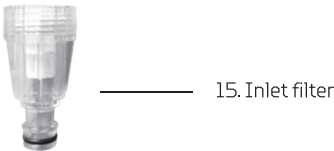
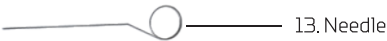
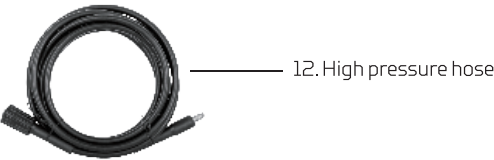

## TECHNICAL DATA

Voltage:	110-120V/60Hz
Wattage:	12 A 1400W
Rated pressure:	70Bar (1000psi)
Max. pressure:	105Bar (1500psi)
Rated flow:	5.0L/min
Degree of protection:	IPX5
Rated temperature:	0-40°C
N.W.:	6kg

**Note:** Operating water pressure and maximum water pressure are obtained in the experimental test environment, which may be different from the actual use environment.

## OPERATION

### 1. ON/OFF SAFETY SWITCH

- 1) Connect the plug into a properly out.
- 2) Trigger switch is in a locked off position to prevent in accidental star. Depress safety lock (d) to "unlocking" position then trigger switch is now on.
- 3) Start the pressure washer by turning ON/OFF switch to ON. Press the trigger. Reminder: motor does not run continuously only when trigger is squeezed.
- 4) Before operating the high pressure washer, press the trigger switch to bleed any trapped air out of the pump and hose.



### 2. SURFACE PREPARATION

- 1) Connect the plug into a properly out.
- 2) Trigger switch is in a locked off position to prevent in accidental star. Depress safety lock (d) to "unlocking" position then trigger switch is now on.
- 3) Start the pressure washer by turning ON/OFF switch to ON. Press the trigger. Reminder: motor does not run continuously only when trigger is squeezed.
- 4) Before operating the high pressure washer, press the trigger switch to bleed any trapped air out of the pump and hose.

### 3. GUN OPERATION

- 1) Rotate to adjust the nozzle

The nozzle controls the shape of the inlet water. Rotate the nozzle to adjust the water shape from a jet to a fan. When using pressure washer to clean wood decks, siding, vehicles etc., always start using the fan spray and begin spraying from a minimum 36" away to avoid damaging the surface of the material you are cleaning.

**Note: the pressure of the spray on the surface you are cleaning increases as you move the wand closer to the surface.**

**⚠ CAUTION: Do not adjust the nozzle while the trigger is squeezed.**

**⚠ CAUTION: Jet spray adjustment is very aggressive. Do not adjust while spraying. We recommend that for most cleaning application applications a 20-degree spray angle should be used to avoid damage to the surface being sprayed.**

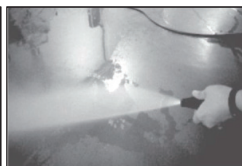

## OPERATION

### 2) Using the soap bottle

To penetrate and remove dirt more effectively it is recommended to use the detergent dispensing function.

Connect the soap bottle into spray lance, until locked in right position.



**NOTE: Detergent need to be diluted to achieve the most effective cleaning. it is recommended to dilute the detergent in suitable container to the required concentration before using.**

### 4. SWITCHING OFF THE APPLIANCE

Turn off the water supply at the tap. Press the trigger to reduce the pressure in the appliance. Pull out the water inlet hose, then let the machine run a few seconds to drain the water of storing in the pump. Switch off the appliance and disconnect the electric plug from the power socket. Detach the pressure hose. To drain the residual water, lift up the jet gun and squeeze the trigger.

### 5. Clean the inlet filter and nozzle

To ensure good performance, check and clean the adapter filter. Remove the filter and rinse with warm water to prevent any foreign matter from clogging the pump. Remove the spray lance from the spray gun; remove any dirt from the nozzle hole and rinse.



### **⚠ WARNING:**

**1. After use, you need to turn off the water, turn off the gun, remove the barrel, and then fire the gun to remove the internal pressure of the product to prevent the product overflow valve from being under pressure for a long time.**

**2. Especially in winter weather, the product needs to be drained and placed indoors to avoid freezing of the water inside the product.**



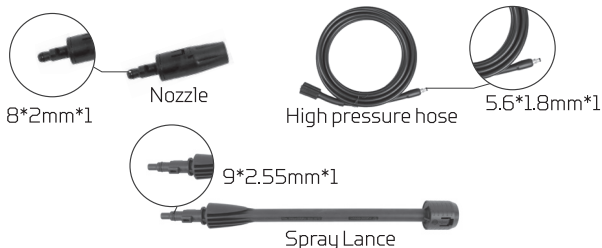

### 6. Service parts: seal ring replacement

**Attention: If the leakage is happened, please check the seal ring. And change it with a new one when the seal ring is failed. Follow the picture, choose the correct seal ring for the replacement.**





## Symbols

	<b>Warning: Do not direct the jet at persons, animals and electrical equipment.</b>
	Read the manual.
	Machine not suitable for connection to the potable water mains
	Double insulation.

## Operating instructions



**NOTE:** Before using the tool ,read the instruction book carefully.



### CAUTION:

- Never use the pressure washer to draw in water contaminated with solvents (e.g. paint thinners, gasoline, oil, etc.).
- Dirt in the feed water will damage the unit. To avoid this risk, we recommended checking the water filter [located inside the water inlet; to clean it out see maintenance section.
- Always prevent debris from being drawn into the unit by using a clean water source and an accessory water source and an accessory water filter if required.

### Water supply (cold water only)

1. Do not draw non-water liquids through the unit. For use with cold water supply only.
2. Water hose must be at least a 1/2" in diameter.
3. Flow rate can be determined by running the water for one minute into an empty container.
4. The water supply temperature must not exceed 40°C (104°F)

**TROUBLESHOOTING**

<b>Problems</b>	<b>Possible causes</b>	<b>Likely Solutions</b>
Machine refuses to start.	1. Machine not plugged in Defective socket. 2. Defective extension cable.	1. Plug in machine. 2. Try another socket. 3. Try without the extension cable.
Fluctuating pressure	1. Pump sucking air. 2. Valves dirty, worn out or stuck. 3. Pump seals worn out.	1. Check that hoses and connections are airtight. 2. Clean and replace or refer to local distributor. 3. Clean and replace or refer to local distributor.
Machine stops	1. Incorrect mains voltage. 2. Thermal cut-out activated. 3. Nozzle partially blocked.	1. Check that the mains voltage corresponds to specification on the model tag. 2. Leave the washer for 5 minutes to cool down. 3. Clean the nozzle.
Machine pulsating	1. Air in inlet hose. 2. Inadequate supply of mains water. 3. Nozzle partially blocked. 4. Water filter blocked. 5. Hose kinked.	1. Check that the mains voltage corresponds to specification on the model tag. 2. Leave the washer for 5 minutes to cool down. 3. Clean the nozzle.
		1. Straighten out hose.
Machine often starts and stops by itself.	1. Pump/spray gun is leaking.	1. Contact your nearest Service.
	1. Pump/hoses or accessory frozen. 2. No Water supply. 3. Water filter blocked. 4. Nozzle blocked.	1. Wait for pump/hoses or accessory to thaw. 2. Connect water supply and turn on. 3. Clean the filter. 4. Clean the nozzle.



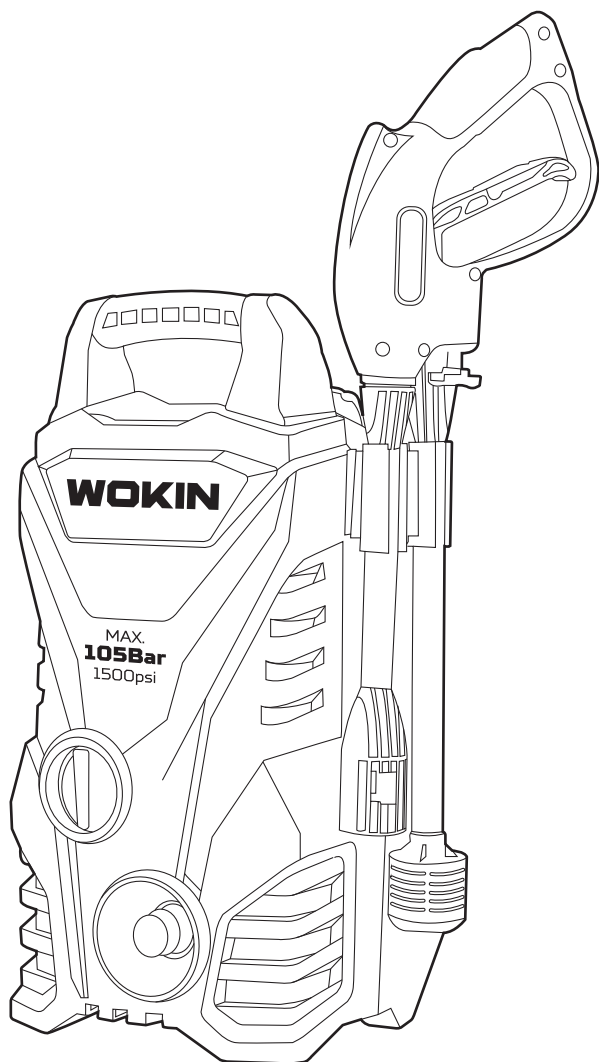

**ZJG WOKIN  
INDUSTRIAL  
CO.,LTD.**

[www.wokintools.com](http://www.wokintools.com)

**PROFESSIONALLY  
MADE IN CHINA**

WOKIN is a trademark or  
registered trademark of  
WOKIN TOOLS.

All rights reserved.



5K02