

WOKIN

PETROL PRESSURE WASHER INSTRUCTION MANUAL

INDUSTRIAL

794417

7.0Hp
5250W

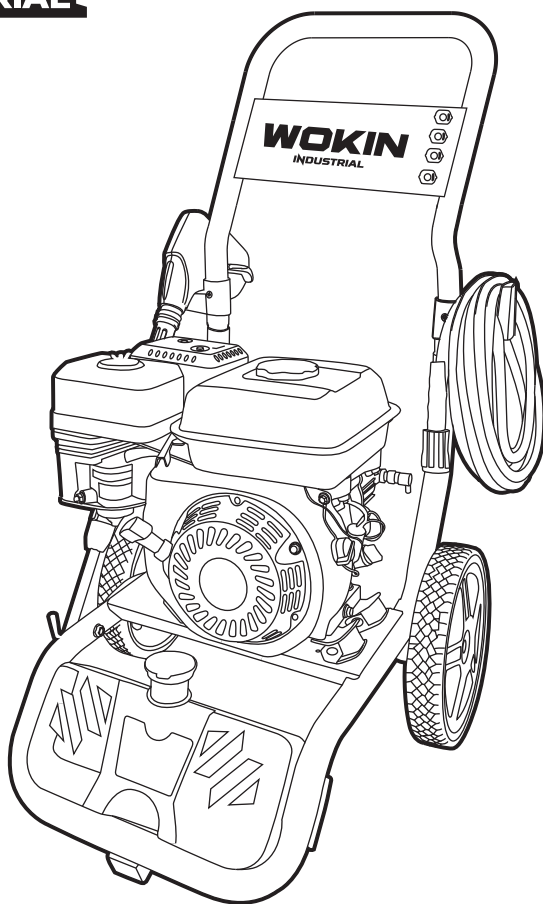

SAVE THIS MANUAL!

You will need this manual for safety instructions, operating procedures and warranty.
Put it and the original sales receipt in a safe dry place for future reference.

IMPORTANT SAFETY INFORMATION

 It is vital that you read and understand this user manual before using the product, including safety warnings, and any assembly and operating instructions. Keep the manual for future reference. Safety precautions and recommendations detailed here must be fully understood and followed to reduce the risk of injury, fire, explosion, electrical hazard, and/or property damage. Safety information presented here is generic in nature—some advice may not be applicable to every product. The term "equipment" refers to the product, be it electrical mains powered, battery powered or combustion engine powered.

- Before Use—If you are not familiar with the safe operation/handling of the equipment or are in any way unsure of any aspect of suitability or correct use for your application, you should complete training conducted by a person or organization qualified in safe use and operation of this equipment, including fuel/electrical handling and safety.
- Do NOT operate the equipment in flammable or explosive environments, such as in the presence of flammable liquids, gases or dust. The equipment may create sparks or heat that may ignite flammable substances.
- Keep clear of moving parts.
- Equipment may be a potential source of electric shock or injury if misused.
- Do NOT operate the equipment if it is damaged, malfunctioning or is in an excessively worn state.
- Do NOT allow others to use the equipment unless they have read this manual and are adequately trained.
- Keep packaging away from children—risk of suffocation! Operators must use the equipment correctly. When using the equipment, consider conditions and pay due care to persons and property.

General Work Area Safety

- Work areas should be clean and well lit.
- Do not operate the equipment if bystanders, animals etc are within operating range of the equipment or the general work area.
- If devices are provided for connecting dust extraction/collection facilities, ensure these are connected and used properly. Dust collection can reduce dust-related hazards

General Personal Safety

- Wear appropriate protective equipment when operating, servicing, or when in the operating area of the equipment to help protect from eye and ear injury, poisoning, burns, cutting and crush injuries. Protective equipment such as safety goggles, respirators, non-slip safety footwear, hard hat, hearing protection etc should be used for appropriate equipment/ conditions. Other people nearby should also wear appropriate personal protective equipment. Do not wear loose clothing or jewellery, which can be caught in moving parts. Keep hair and clothing away from the equipment.
- Stay alert and use common sense when operating the equipment. Do not overreach. Always maintain secure footing and balance.
- Do not use the equipment if tired or under the influence of drugs, alcohol or medication.
- This equipment is not intended for use by persons with reduced physical, sensory or mental capabilities.

General Fuel Safety

- Petrol/fuel/gasoline is extremely flammable keep clear of naked flames or other ignition sources.
- Do not spill fuel. If you spill fuel, wipe it off the equipment immediately — if fuel gets on your clothing, change clothing.
- Do NOT smoke near fuel or when refuelling.
- Always shut off the engine before refuelling.
- Do NOT refuel a hot engine.
- Open the fuel cap carefully to allow any pressure build-up in the tank to release slowly.
- Always refuel in well ventilated areas. Always check for fuel leakage. If fuel leakage is found, do not start or run the engine until all leaks are fixed.

General Carbon-Monoxide Safety

- Using a combustion engine indoors CAN KILL IN MINUTES. Engine exhaust contains carbon-monoxide—a poison you cannot smell or see.
- Use combustion engines OUTSIDE only, and far away from windows, doors and vents.

General Equipment Use and Care

- The equipment is designed for domestic use only.
- Handle the equipment safely and carefully.
- Before use, inspect the equipment for misalignment or binding of moving parts, loose components, damage or any other condition that may affect its operation. If damaged, have the equipment repaired by an authorised service centre or technician before use.
- Prevent unintentional starting of the equipment—ensure equipment and power switches are in the OFF position before connecting or moving equipment. Do not carry equipment with hands or fingers touching any controls. Remove any tools or other items that are not a part of the equipment from it before starting or switching on.
- Do not force the equipment. Use the correct equipment for your application. Equipment will perform better and be safer when used within its design and usage parameters.
- Use the equipment and accessories etc. in accordance with these instructions, considering working conditions and the work to be performed. Using the equipment for operations different from those intended could result in hazardous situations.
- Always keep equipment components (engines, hoses, handles, controls, frames, housings, guards etc) and accessories (cutting tools, nozzles, bits etc) properly maintained. Keep the equipment clean and where applicable, properly lubricated.
- Store the equipment out of reach of children or untrained persons. To avoid burns or fire hazards, let the equipment cool completely before transporting or storing. Never place or store the equipment near flammable materials, combustible gases or liquids etc.
- The equipment is not weather-proof, and should not be stored in direct sunlight, at high ambient temperatures or locations that are damp or humid.
- Do not clean equipment with solvents, flammable liquids or harsh abrasives.
- For specific equipment safety use and care, see Equipment Safety.

General Electrical Safety

- Inspect electrical equipment, extension cords, power bars, and electrical fittings for damage or wear before each use. Repair or replace damaged equipment immediately.
- Ensure all power sources conform to equipment voltage requirements and are disconnected before connecting or disconnecting equipment.
- When wiring electrically powered equipment, follow all electrical and safety
- Wherever possible, use a residual current device (RCD).
- High voltage/high current power lines may be present. Use extreme caution to avoid contact or interference with power lines. Electrical shock can be fatal.
- Electrically grounded equipment must have an approved cord and plug and be connected to a grounded electrical outlet.
- Do NOT bypass the ON/OFF switch and operate equipment by connecting and disconnecting the electrical cord.
- Do NOT use equipment that has exposed wiring, damaged switches, covers or guards.
- Do NOT use electrical equipment in wet conditions or in damp locations.
- Do NOT use electrical cords to lift, move or
- Do NOT coil or knot electrical cords, and ensure electrical cords are not trip hazards.

General Service Information

- The equipment must be serviced or repaired at authorised service centres by qualified personnel only.
- Replacement parts must be original equipment manufacturer (OEM) to ensure equipment safety is maintained.
- Do NOT attempt any maintenance or repair work not described in this manual.
- After use, the equipment and components may still be hot—allow the equipment to cool and disconnect spark plugs and/or electrical power sources and/or batteries from it before adjusting, changing accessories or performing repair or maintenance.
- Do NOT adjust while the equipment is running.
- Perform service-related activities in suitable conditions, such as a workshop.
- Replace worn, damaged or missing warning/safety labels immediately.

Pressure Cleaner Washer Safety

Read and understand this manual in its entirety before operating this pressure washer. Improper use of this pressure washer could result in serious injury or death.

Never spray near a power source such as an electrical outlet. Making contact with a power source could cause an electric shock or burn.

Do not operate indoors or in a confined space preventing dangerous carbon monoxide gas from dissipating.

- Carbon monoxide gas is a poisonous, odourless gas that can cause headache, confusion, fatigue, nausea, fainting, sickness, seizures, or death. If you start to experience any of these symptoms, IMMEDIATELY get fresh air and seek medical attention.
- Never use indoors, in a covered area, or in a confined space, even if doors and windows are open.
- Keep exhaust from this unit from entering a confined area through windows, doors, vents, or other openings.
- When working in areas where vapours could be inhaled, use a respirator mask according to all its instructions.

To reduce the risk of injection, injury or possible amputation, never direct water pressure towards people or pets.

- The high-pressure stream of water produced can cut through skin and underlying tissue. Never squeeze the trigger or point the spray gun at other people, animals, plants, or fragile objects such as glass, even if the engine is stopped.
- This unit is not a toy. Keep unit away from children and pets.
- Do not leave spray gun unattended while unit is running.
- Make sure the spray gun, nozzle, and accessories are attached correctly.
- Never attempt to repair high pressure hose, always replace.
- Never attempt to repair leaks with sealant, always replace O-ring or seal.
- Never attempt to connect or disconnect hose from pump or spray gun while system is pressurised.
- Always release water pressure from unit every time you stop the engine.

Moving parts can catch on clothing, jewellery, and hair.

- Do not wear loose clothing or gloves.
- Remove jewellery or anything else that could be caught in moving parts.
- Tie back or wear protective head covering to contain long hair.
- Pressure washer can create puddles and slippery surfaces.
- Never wear sandals, always wear protective footwear.
- Operate pressure washer from a level and stable surface.
- Do not operate from a ladder, scaffolding, or uneven surface as recoil from spray gun could cause you to fall.
- Use both hands to control spray gun to control recoil.
- Do not over-extend yourself in attempt to reach a little further.

Keep engine away from flammable objects and other hazardous materials.

- The fuel and its vapours used to power this unit are highly flammable and could explode resulting in serious injury or death.
- Never overfill fuel tank. If fuel spills, move the unit at least 30 feet away from the spill and wipe up any remaining fuel on the unit before starting the engine.
- Never smoke while operating or fuelling this unit.
- Never operate or store this unit near an open flame, heat, or any other ignition source.
- Keep engine free of grass, leaves, or grease which are flammable.

- When adding or draining fuel, unit should be turned off for at least 2 minutes to cool before removing fuel cap. If unit has been running the fuel cap is under pressure, remove slowly.
- To keep fuel from spilling, secure unit so it cannot tip while operating or transporting.
- When transporting unit, disconnect the spark plug wire and make sure the fuel tank is empty with the fuel shutoff valve turned to the off position.

Stay alert and use common sense. Do not operate this unit if you are under the influence of alcohol, drugs, medication or you feel tired—Pull cord recoils rapidly and pulls arm towards engine faster than you can let go which could result in injury.

- Always relieve pressure from spray gun before pulling starter cord, including every failed attempt to start engine.
- To avoid recoil, pull starter cord slowly until resistance is felt, then pull rapidly.

Never operate this unit if there are any broken or missing parts and only use PIPE replacement parts specifically designed for this unit.

- Improper treatment of pressure washer can damage the unit and shorten its life.
- Always repair this unit as specified in this manual. If you have any questions, contact our Authorised Dealer.
- Never modify this unit in any way or modify governed speed.

Avoid contacting hot areas of this unit.

- Use caution around the muffler and other engine parts as they can be extremely hot.
- Allow hot components to cool before touching.

Only use this unit as it is intended, or serious injury or death could result.

- Do not bypass any safety device. Moving parts are covered with guards. Make sure all protective covers are in place.
- Inspect hoses and connections making sure they are secure before starting engine.
- Use only recommended accessories to avoid damage to this unit.
- Never transport or make adjustments to this unit while it is running.

Use indirect vented safety goggles designed for wet conditions to protect eyes from injury.

- Spray from this unit has extreme pressure and can ricochet back splashing water or propelling objects towards eyes.
- Never substitute eye protection with dry condition goggles.

Only use detergents or soaps that are safe to be used with pressure washers. Chemicals which are caustic, such as acids or bleach, can result in serious injury, property damage, damage to pressure washer, or death.

DANGER

Using an engine or wood/charcoal/gas fuelled appliance indoors CAN KILL YOU IN MINUTES. Engine exhaust and wood/charcoal/gas fumes contain carbon monoxide. This is a poison you cannot see or smell.



NEVER use inside a building, home, garage, boat, caravan or tent EVEN IF doors and windows are open.



Only use OUTSIDE and far away from windows, doors, and vents.

Avoid other hazards - READ MANUAL BEFORE USE.

GENERAL:

- Do not operate in a hazardous location. Such areas include where there is a risk of explosion of petrol fumes, leaking gas or explosive dusts.
- Do not operate in a confined area where exhaust gases or wood/charcoal/gas fumes could reach dangerous concentrations.

PRODUCTS FEATURING AN ENGINE













- Follow all warnings in the section titled "GENERAL".
- Explosion hazard—never smoke while refuelling.
- Take care not to spill fuel! When refuelling the engine, ensure that the engine has been allowed to cool. Prevent spilling of fuel as this may also ignite with a hot engine.
- Never refuel while engine is running.

GENERATORS

- Follow all warnings in the sections titled "GENERAL" and "PRODUCTS FEATURING AN ENGINE". The output of this generator is potentially lethal.
- The generator should not be connected to a fixed electrical installation except by an appropriately licensed person.
- Not weatherproof—protect your machine. This machine is not weatherproof and should not be exposed to direct sunlight, high ambient temperature, damp conditions, wet conditions or high humidity conditions.

Note: Symbology

The product may have safety warning labels attached to it, explained below. Understand the symbols on your product and their meanings. If any stickers become unreadable, unattached etc., replace them.

 <p>Flammable Material Hazard Flammable liquids, gases or substances etc may present. Avoid ignition sources and open flames. Danger of fire.</p>	 <p>Read User Manual Read and fully understand and product safety warnings, operation, procedures etc before using the product.</p>	 <p>Use Hand Protection Wear appropriate hand protection and take due care as the product or use of the product may present hand hazards.</p>	 <p>Carbon-Monoxide Hazard Do not use the product in confined areas or without adequate ventilation. Carbon-monoxide poisoning can be fatal.</p>
 <p>Electrocution/Electrical Shock Hazard High voltage or high current electricity may be present or required by the product. Take due care when handling electrical products, cables, plugs and leads. Electrical shock can be fatal.</p>	 <p>Toxic Fumes / Dust Hazard Using the product or by-products from use may produce fumes, smoke or particles that could be harmful if inhaled. Wear appropriate breathing protection and have adequate ventilation.</p>	 <p>Explosive Material Hazard combustible liquids, gases or substances etc may be present. Avoid ignition sources and open flames. Danger of explosion.</p>	 <p>Cutting/Amputation Hazard The product may have blades, edges or mechanical devices that can cause severe cut injury to fingers, limbs etc. Take due care when handling and using the product.</p>
 <p>Crush Hazard The product may have blades, edges or mechanical devices that can cause severe crush injury to fingers, limbs etc. Take due care when handling and using the product.</p>	 <p>Single Operator Only The product must be operated by a single person only. More than one person operating the product may introduce additional hazards.</p>	 <p>Use Face Protection Wear appropriate full-face protection and take due care as the product or use of the product may present face and eye hazards.</p>	 <p>Use Foot Protection Wear appropriate foot protection and take due care as the product or use of the product may present foot hazards.</p>
 <p>Use Eye / Ear / Head Protector Wear appropriate eye and / or ear and / or head protection and take due care as the product or use of the product may present eye, hearing and head hazards.</p>	 <p>Running Hazard Do not run on or near the product as doing so may present a fall hazard.</p>	 <p>Diving Hazard Do not dive into the product as doing so may present a neck / head injury hazard.</p>	 <p>Adult Supervision Required Always supervise children and other users of a product to prevent drowning or injury.</p>
 <p>Skin Penetration / Puncture Hazard The product may produce pressure, emit liquids or objects that can cause severe injury to fingers, limbs, blood etc. Take due care when handling and using the product, and head hazards.</p>	 <p>Hot Surface Hazard Be aware that the product may produce high temperatures and hot surfaces that can cause burn injuries.</p>	 <p>Flying Debris Hazard Be aware that the product or use of the product may present hazards produced by flying debris. Wear appropriate clothing and protective devices.</p>	 <p>Moving Parts Hazard Be aware that the product contains or uses mechanical devices that move or rotate. Always wait for moving parts to stop fully before handling the product, adjusting, maintenance etc.</p>

 <p>Carbon-Monoxide Hazard Do not use the product in confined areas or without adequate ventilation. Carbonmonoxide poisoning can be fatal.</p>	 <p>Pull Hazard Be aware that the product contains or uses mechanical devices that can pull in objects and can cause severe injury to fingers, limbs etc. Take due care when handling and using the product.</p>	 <p>Slope / Fall Injury Hazard Be aware that using the product on sloping surfaces or in slippery conditions may present additional dangers from falls and contact with blades, moving parts, hot surfaces etc.</p>	 <p>"Slam Dunk" Warning Do NOT attempt "slam dunk" manoeuvres as this may result in severe injury due to falling, product breakage or collapse etc.</p>
 <p>Electrocution/Electrical Shock Hazard – Outdoor High voltage or high current electricity may be present or required by the product. Do NOT use in rain, damp or wet conditions. Electrical shock can be fatal.</p>	 <p>Electrocution/Electrical Shock Hazard – Disconnect High voltage or high current electricity may be present or required by the product. Always disconnect the product from the electrical supply before handling the product, adjusting, maintenance etc.</p>	 <p>Power Line Electrocution Hazard High voltage / high current power lines may be present. Use extreme caution to avoid contact or interference with power lines. Electrical shock can be fatal.</p>	 <p>"Kick-Back" Hazard High level of "kick-back" hazard that can cause the machine to suddenly rotate towards operator. Kick-back injury can be fatal.</p>
 <p>Winch Operator Position Hazard Do NOT stand between winch and load. Do NOT use winch to move people.</p>	 <p>Winch Lift Hazard Do NOT LIFT load vertically. Use machine to PULL only.</p>	 <p>Cable Hazard Ensure that load bearing cable is not kinked or knotted.</p>	 <p>Winch Cable Hazard Ensure that there is a minimum number of cable coils on winching mechanism.</p>
 <p>Winch Hook Hazard Carry hook to load – do NOT throw or run.</p>	 <p>Flash / Blinding Hazard Wear appropriate eye protection for welding. Direct exposure to weld arcs may cause permanent eye injury.</p>	 <p>Laser Hazard Laser may be in use – do NOT look directly at laser or allow others to.</p>	

SPECIFICATIONS

Max. output power	5250W/7.0HP
Engine	212CC
Oil capacity	0.6L
Fuel tank capacity	3.6L
Rated Pressure	180bar (2610psi)
Max. Pressure	200bar (2900psi)
Water Flow	8L/min

FUNCTIONS

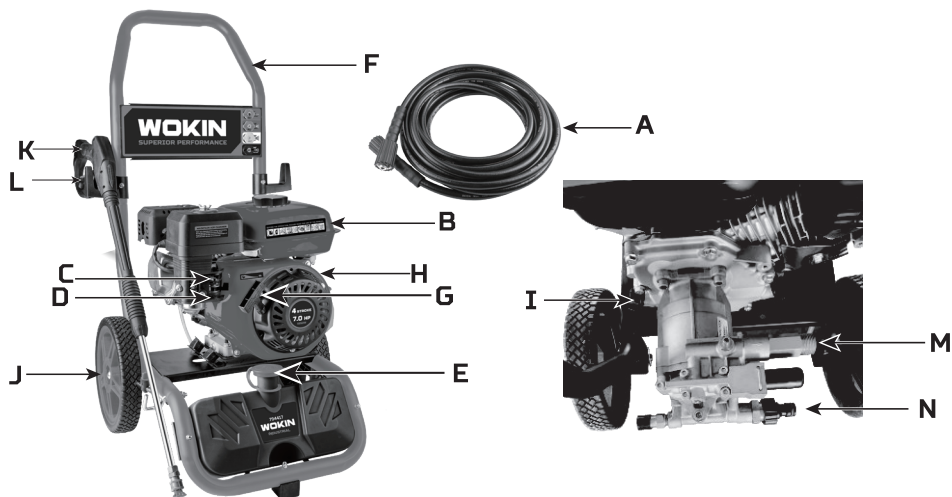

No	Name	No	Name
A	High pressure hose	H	Engine ON/OFF switch
B	Fuel tank and cap	I	Oil fill and dipstick
C	Choke	J	No-flat foam-filled tyres
D	Fuel valve lever	K	Spray gun
E	Soap bottle	L	Locking trigger
F	Handle	M	High-pressure hose outlet
G	Pull cord	N	Water inlet

ASSEMBLY

⚠ Do not attempt to assemble or operate this pressure washer until you have read and understood this entire manual. If you have any problems assembling or operating this unit, contact an authorised dealer or a qualified service centre. Do not operate this pressure washer if any of the parts are damaged or missing until the part is replaced. Using this product with damaged or missing parts can cause damage to the machine or result in serious injury or death.

Unpacking

1. Remove the high-pressure hose from the box.
2. After the high-pressure hose has been removed, carefully open product by cutting down the sides of the box.
3. Remove the product, parts, and all accessories. Make sure all items listed on the packing list are included and not damaged.

Attaching The Foot Assembly

Parts needed-1 foot, 1 M8 lock nuts.

1. Raise or tilt pressure washer so you can line up foot with the hole located at the centre of the frame.
2. Align the rubber foot with the hole in the frame where the foot is to be located. Attach foot by inserting the bolt from the bottom up and install the acorn nut. Wrench tighten until there is a slight crush on the frame tube (do not over tighten).

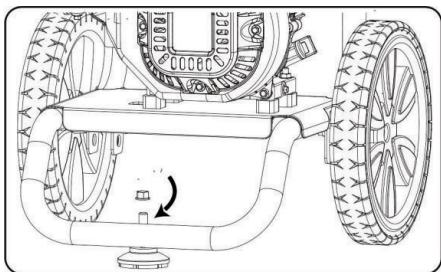

Installing The Handle

Install inner frame (handle) onto the lower frame by sliding the handle over the two upright tubes on the lower frame and pressing down firmly until the handle is seated and the two detent pins snap in place.

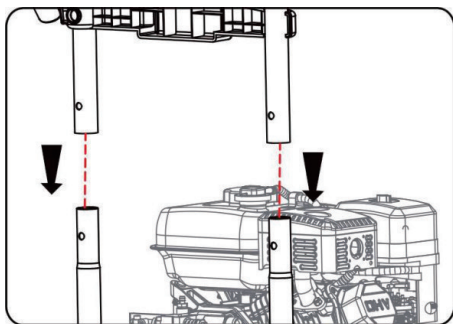

Attaching The Spray Gun

1. Screw the spray wand and the trigger handle together until they are secure.
2. Insert the inlet coupler of the spray hose into the threaded fitting on the high pressure spray gun and thread the black nut on by turning clockwise until it is hand tight.

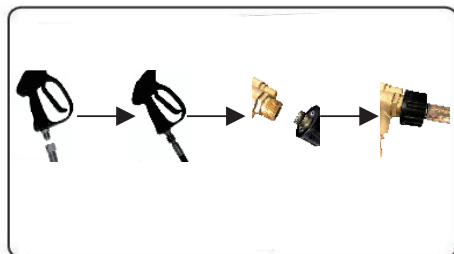
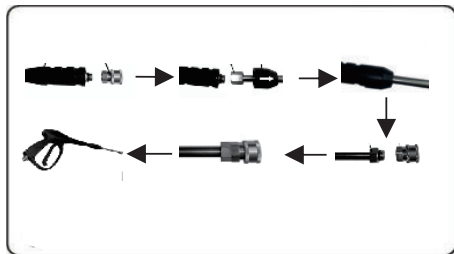

High Altitude Operation

At high altitude, the standard carburettor air/fuel mixture will be too rich. Performance will decrease, and fuel consumption will increase. A very rich mixture will also foul the spark plug and cause hard starting. Operation at an altitude that differs from that at which this engine was certified, for extended periods of time, may increase emissions. High altitude performance can be improved by specific modifications to the carburettor. If you always operate your generator at altitudes above 5,000 feet (1,500 meters), have your dealer perform this carburettor modification. This engine, when operated at high altitude with the carburettor modifications for high altitude use, will meet each emission standard throughout its useful life. Even with carburettor modification, engine horsepower will decrease about 3.5% for each 1,000-foot (300-meter) increase in altitude. The effect of altitude on horsepower will be greater than this if no carburettor modification is made.

Adding /Checking Engine Oil

1. Place pressure washer on a level surface.
2. Remove one or both crankcase dipsticks to ensure you do not overfill the engine.
3. Carefully add between 520 ml (17.5 oz) of 4-Cycle engine oil (SAE10W30) to empty reservoir until oil reaches the outer edge of the oil fill hole (Crankcase Dipstick hole).
4. Be sure to replace both dipsticks before attempting to start the engine.
5. To check oil, set pressure washer on a level surface, wipe dipstick clean, then reinsert dipstick without rethreading.

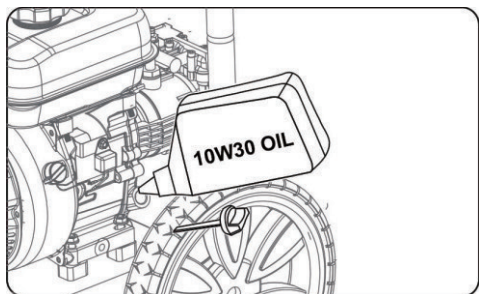

Adding Fuel



Oil must be added to unit prior to first use.
To avoid spillage, do not overfill fuel tank as gasoline expands.

1. Set pressure washer on a clean and level surface in an area that is well ventilated.
2. Remove fuel cap.
3. Insert a funnel into the fuel tank and carefully pour gasoline into the tank until fuel level reaches 1 1/2 inches below the top of the neck.



Connecting The Garden Hose To Pressure Washer

⚠ Do not run pump without connecting to the water supply and turning water on. Failure to do so could damage the pressure washer. Failure to follow these instructions will void product warranty.

1. Run water through the hose for a few seconds to flush any debris from the hose.
2. Inspect inlet screen and remove any debris.
3. Connect hose to water inlet and tighten by hand. There must be a minimum of 10 feet of unrestricted hose between pressure washer and faucet or shut off valve.
4. Turn on the water.
5. Purge the system's pump of air by releasing the safety and squeezing the trigger of the spray gun.

Connect High Pressure Hose To Pump

1. Attach end of high pressure hose to the high pressure outlet on pump.
2. Follow the same procedure with opposite end to attach high pressure hose to spray wand.

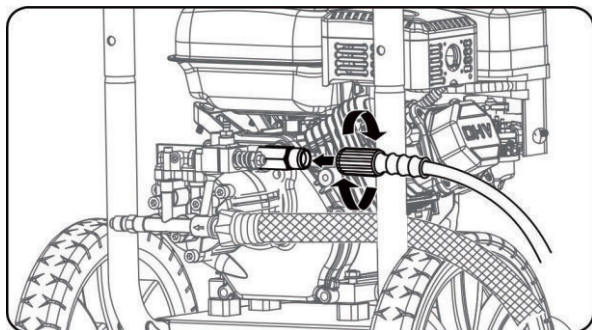

OPERATION

⚠ Do not operate indoors or in a confined space preventing dangerous carbon monoxide gas from dissipating.

- Carbon monoxide gas is a poisonous, odourless gas that can cause headache, confusion, fatigue, nausea, fainting, sickness, seizures, or death. If you start to experience any of these symptoms, IMMEDIATELY get fresh air and seek medical attention.
- Never use indoors, in a covered area, or in a confined space, even if doors and windows are open.
- Keep exhaust from this unit from entering a confined area through windows, doors, vents, or other openings.
- When working in areas where vapours could be inhaled, use a respirator mask according to all its instructions.
- Do not run pressure washer with a damaged hose. Do not run pressure washer without first connecting and turning on water supply or damage to the pressure washer could result. **FAILURE TO FOLLOW THESE INSTRUCTIONS WILL VOID PRODUCT WARRANTY.**

Pre-Operation Checklist

- Read and understand this operator manual in its entirety before operating pressure washer.
- Check oil level and add oil to the proper level if low.
- Check fuel level and add fuel if needed.
- Check connections of handle and all hoses to make sure they are secure.
- Check all hoses for kinks and damage.
- Check flow of water supply and make sure it is adequate (40-80PSI).

Starting The Pressure Washer

1. Place pressure washer on a level surface.
2. Turn on the water.
3. Purge the system's pump of air by releasing the safety and squeezing the trigger of the spray gun.
4. Attach wand/lance to spray gun.
5. Turn fuel valve to the ON position.
6. Slide the choke lever to the "Choke" position.
7. Turn the engine OFF/ON switch to the "ON" position.
8. Holding the machine with your hand, pull the recoil handle [starter cord] slowly until resistance is felt, then pull rapidly. Squeeze the Gun trigger and release the pressure after every failed attempt to start the pressure washer (This will reduce the back pressure).
9. Let engine run for several seconds and then gradually slide the choke lever to the RUN position as the engine warms up until the choke is fully slid to the RUN position.

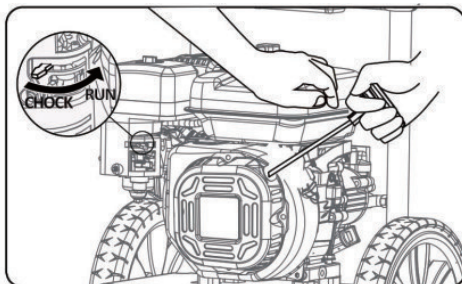
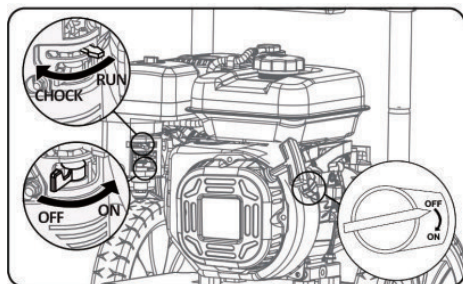

⚠ Pull cord recoils rapidly and pulls arm towards engine faster than you can let go which could result in injury.

- Always relieve pressure from spray gun before pulling starter cord, including every failed attempt to start engine.
- To avoid recoil, pull starter cord slowly until resistance is felt, then pull rapidly.

Using The Spray Gun

1. Flip the lock tab behind the trigger up or down until it clicks to apply or remove the safety. Pull back on the trigger to begin operating pressure washer.
2. To stop water flow, release the trigger.

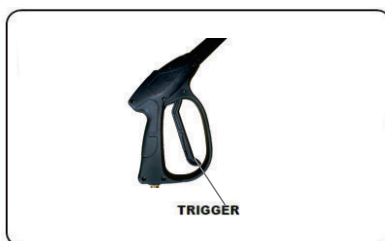
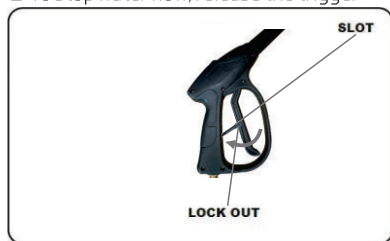

Using The Spray Nozzle

- To connect or disconnect spray tip, pull back on the quick-connect collar. Insert or remove spray tip then release collar.
- When spray tip is connected, pull on the spray tip to make sure it is secured
- For general cleaning use the 40° spray tip. This option is for cement walkways.
- For stripping, spot cleaning, blasting, and hard to reach areas use the 15° spray tip. This option is for removing paint, rust, mildew, marine growth off boats, or grease stains. This option can be used for reaching second story surfaces, or for the removal of paint, rust, oil stains, tar, gum, and other stubborn substances. Use extreme caution when using this nozzle.
- For applying pressure washer safe detergent, use the black soap nozzle.

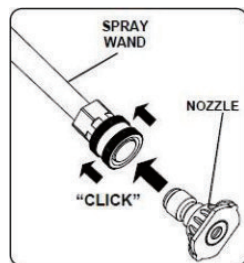

Applying Detergent

1. Rinse surface with cool water before applying cleaner.
2. Prepare detergent as required by job. For best results follow detergent directions as supplied from manufacturer.
3. Remove cap from detergent container and fill.
4. Spray detergent on surface. For best results use long, even, and overlapping strokes. Allow detergent to set for about 3 minutes before rinsing, but do not allow detergent to dry on surface or it may cause streaking or cause damage to the surface. Use good judgment.
5. To clean equipment after use, flush water through the spray nozzle for 1-2 minutes then shut off engine. Soak nozzle in a bucket of clean water to remove detergent.

⚠️ Only use detergents or soaps that are safe to be used with pressure washers. Chemicals which are caustic, such as acids or bleach, can result in serious injury, property damage, or death.

Rinsing With The Pressure Washer

1. Test a small area first to avoid surface damage.
2. Rinse from top to bottom using long, overlapping strokes.

Moving The Pressure Washer

1. Turn the pressure washer off.
2. Tilt unit towards you until it is balanced on its wheels.
3. Roll machine to desired location.

MAINTENANCE

 **Before inspecting or servicing this machine, make sure the engine is off and no parts are moving. Disconnect the spark plug wire and move it away from the spark plug.**

Regular maintenance will extend the life of this pressure washer and improve its performance. The warranty does not cover items that result from operator negligence, misuse, or abuse. To receive full value from the warranty, operator must maintain the pressure washer as instructed in this manual, including proper storage.

Pre-Operation Steps

Before starting the engine, perform the following pre-operation steps:

- Check the level of the engine oil and the fuel tank level
- Remove any debris that has collected on the pressure washer.
- Check water inlet screen for damage. Clean inlet screen if it is clogged.
- Check high pressure hose for damage.
- Briefly run garden hose to flush out any debris or insects.
- Inspect the work area for hazards.

Removing Debris

- Clean any debris that has collected around or behind the muffler, cleaning system, and controls.
- Use a damp cloth to wipe exterior surfaces. If dirt is caked on, use a soft bristle brush.

After Each Use

Follow the following procedure after each use:

- Shut off engine and turn off water supply. Release water pressure by pointing spray gun in a safe direction and squeezing the trigger.
- Disconnect high pressure hose, spray gun, and nozzle. Drain water from items and use a rag to wipe down the outside of the hose and spray gun.
- Empty the water from the pump by pulling the recoil starter 6 times.
- Store unit in a clean and dry area.
- Use of a pressure washer pump conditioner is recommended, follow the instructions provided by the manufacturer of the pump conditioner.

Maintenance Schedule

After First 5 Hours	Change Engine Oil
After Each Use	Check and Clean Water Inlet screen
	Check High Pressure Hose
	Check and Clean Detergent Siphoning Tube
	Check Spray Gun for Leaks
	Clean Debris
	Check Engine Oil Level before starting
Annually (20 hr. Use)	Change Engine Oil (Service more often under dirty or dusty conditions)
Annually (50 hr. Use)	Check and Clean Air Filter
	Check muffler and spark arrester
Annually (100 hr. Use)	Service or Replace Spark Plug

Changing The Engine Oil

Engine oil will drain better if the engine is still warm, but not hot.

1. Shut off engine.
2. Clean the area around the oil fill cap/dipstick to keep out debris then remove oil fill cap/dipstick.
3. Place an oil pan on the ground to catch oil. Remove oil plug then tilt pressure washer back and to the side to empty out the oil from the crankcase.
4. Once oil is completely drained, return the pressure washer to a level position and install the oil drain plug. Refill the engine with new oil as instructed earlier in this manual under Adding / Checking Oil.

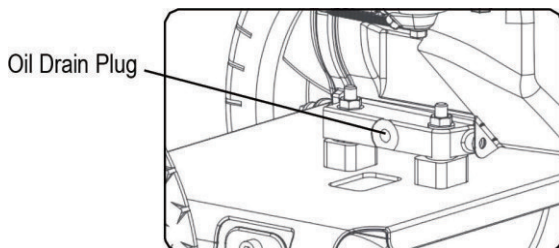

Checking The Detergent Siphoning Tube

1. Check the detergent siphoning tube for clogs, leaks, or tears.
2. Ensure that the tube fits tightly to the pump fitting.
3. Replace siphoning tube if damaged.

⚠ Never repair high pressure hose or use unit if hose is damaged. If hose is damaged, replace with identical part/s.

High Pressure Hose

- Inspect hose for cuts, bulges, or leaks which can develop from kinking or wear.
- If damage is found, immediately replace hose. Inspect couplings for damage. Immediately replace hose if damage is found.

Spray Gun

- Ensure that the spray gun is connected securely.
- Inspect the spray gun safety and make sure the spray gun trigger springs back upon release.

Spray Nozzle

If a pulsing sensation is felt while squeezing the trigger, the spray nozzle may be dirty or clogged and should be cleaned immediately.

1. To clean the nozzle, shut off the engine and turn off the water.
2. Remove the nozzle from the spray wand making sure that the nozzle is pointing away from you and in a safe direction.
3. Use the nozzle cleaner or a small paper clip to dislodge any foreign materials which are clogging or restricting the spray tip.
4. Flush debris out of the nozzle by back flushing with a garden hose for 30-60 seconds.
5. Reconnect the nozzle to the spray wand.
6. Turn the water supply back on and start engine.



Checking The Spark Plug

1. Disconnect the spark plug wire from the spark plug.
2. Before removing the spark plug, clean the area around its base to prevent debris from entering the engine.
3. Clean carbon deposits off the electrode with a wire brush.
4. Check the electrode gap and slowly adjust to 0.80mm (0.031in.) if necessary.
5. Reinstall spark plug and tighten to Torque 22.0-26.9 Nm (16-20 ft-lb).
6. Reconnect spark plug wire.
7. If spark plug is worn replace only with an equivalent replacement part. Spark plug should be replaced annually.

 **Water pressure produced by this unit can cut through skin and tissue leading to serious injury and possible amputation..Never attempt to repair high pressure hose, always replace. . Never attempt to repair leaks with sealant, always replace O-ring or seal.**

Repairing Leaking Connections

Purchase O-Ring/Maintenance kits through an authorised dealer and follow instructions provided with the kit.

Air Filter

A dirty air filter will reduce the life span of the engine, make starting the engine difficult, and reduce the unit's performance.

1. To clean, remove the air filter cover.
2. Carefully pull the air filter out by lifting along the edges.
3. Remove dirt from filter by tapping on it or having it blown out.
4. Reinstall air filter so that it seals and replace air filter cover.

 **Storage cover could be flammable. Let engine cool before covering the pressure washer.**

Storing the Pressure Washer

 **IMPORTANT! Do not store or transport this unit on anything other than a 90-degree angle. Tilting or laying the unit on its side will result the carburettor flooding with oil which will lock up the engine.**

If storing pressure washer for 30 days or more follow the procedures below:

1. Add fuel stabiliser to unleaded petrol to keep the petrol from going stale and to prevent gum deposits from forming on the carburettor. Run engine for a couple of minutes to circulate the fuel stabiliser.
2. Empty fluid from all hoses and pump.
3. Disconnect the spark plug wire and clean the spark plug. Leave spark plug wire disconnected.
4. Clean the air filter.
5. Cover unit with a suitable protective cover to keep unit dry.
6. Store unit in a frost-free area.

TROUBLESHOOTING

Problem	Possible causes	Likely solutions
Engine does not start.	<ol style="list-style-type: none"> 1. Out of fuel. 2. Engine oil low. 3. Spark plug wire disconnected from spark plug. 4. Bad spark plug. 5. Spark plug wire has shorted. 6. Ignition inoperative. 	<ol style="list-style-type: none"> 1. Out of fuel. 2. Engine oil low. 3. Spark plug wire disconnected from spark plug. 4. Bad spark plug. 5. Spark plug wire has shorted. 6. Ignition inoperative.
Engine hard to start.	<ol style="list-style-type: none"> 1. Stale fuel or water in fuel. 2. Spark plug producing weak spark. 3. Excessively rich fuel mixture. 	<ol style="list-style-type: none"> 1. Drain fuel and refill with fresh fuel. 2. Contact an authorised dealer. 3. Contact an authorised dealer.
Engine lacks power and vibrates excessively.	Dirty air filter.	Clean air filter.
Engine quits during operation.	Out of fuel.	Re-fill fuel tank.
Engine loses power when load is added.	Engine speed is too slow.	Move throttle to fast. If this does not correct problem, contact an authorised dealer.
Water pressure is weak.	<ol style="list-style-type: none"> 1. Water supply is restricted. 2. Water not turned on to full power. 3. Not using high pressure nozzle. 	<ol style="list-style-type: none"> 1. Inspect garden hose for kinks or leaks. Make sure you are using a large enough garden hose (min. 3/4 inch diameter). 2. Open water source all the way. 3. Change nozzle.
Detergent and spray do not mix.	<ol style="list-style-type: none"> 1. Detergent hose is not submerged or has disconnected. 2. Black soap nozzle needed. 	<ol style="list-style-type: none"> 1. Ensure that hose is connected and submerged in the detergent 2. Install soap nozzle.
Pump fails to produce pressure or pressure is inconsistent.	<ol style="list-style-type: none"> 1. Water supply is restricted. 2. Water not turned on full power. 3. Nozzle is clogged. 4. Spray gun leaks. 5. Air in line. 6. Inlet hose screen is clogged 7. Water supply is over 100°F 8. Pump is faulty. 	<ol style="list-style-type: none"> 1. Inspect garden hose for kinks or leaks. Ensure that you are using a large enough garden hose (min. inch diameter). 2. Open water source all the way 3. Clean nozzle. 4. Check spray gun connection or replace spray gun. 5. Squeeze trigger handle to remove air. 6. Clean inlet 7. Use cool water supply. 8. Contact an authorised dealer.

PARTS LIST

NO.	PART NAME	QTY
1	Handle	1
2	Holder	2
3	Soap bottle	1
4	Wheel	1
5	Cushion	4
6	Frame	1
7	Shock absorbing block	1
8	Engine	1

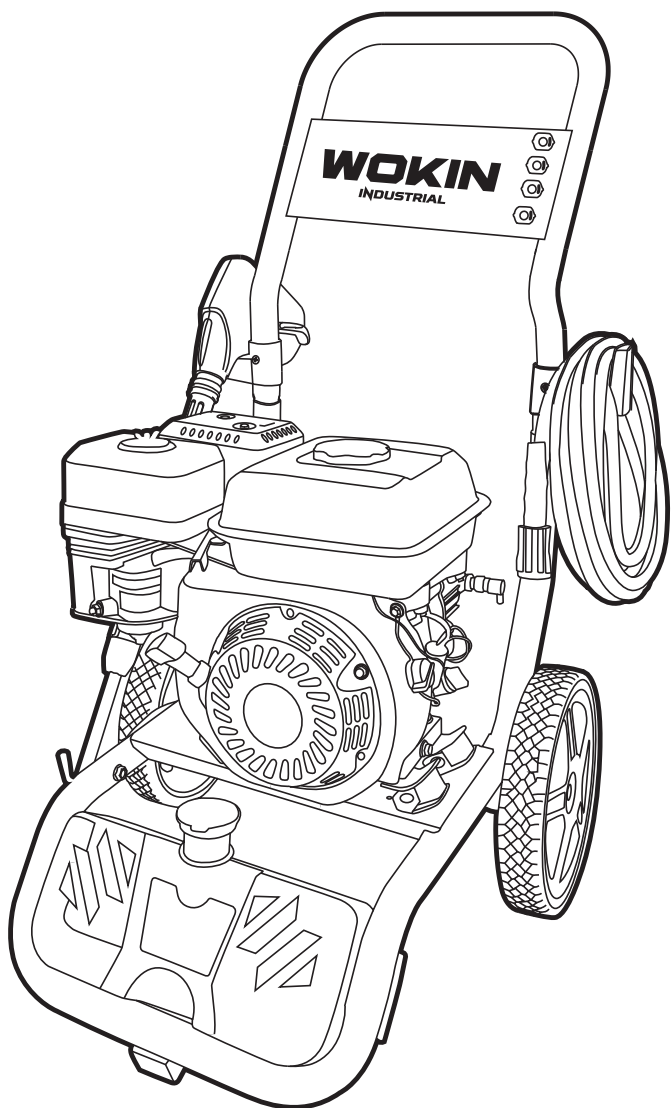

**ZJG WOKIN
INDUSTRIAL
CO.,LTD.**

www.wokintools.com

**PROFESSIONALLY
MADE IN CHINA**

WOKIN is a trademark or
registered trademark of
WOKIN TOOLS.

All rights reserved.



SD10